

## Mounting Configuration

### 5GHz 23dBi Flat Panel Directional Antenna

#### Pole Mount

There are up/down and left/right tilting features for both vertical and horizontal polarization orientations.

Please make sure you have installed the ANT-FP23A of the same polarization with the other corresponding antenna of the outdoor AP.

##### Vertical Polarization

##### Vertical Pole Mounting:

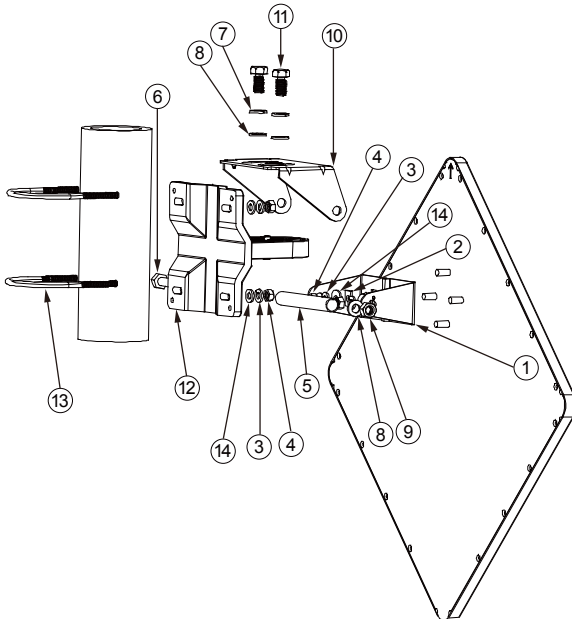

##### Vertical Polarization

##### Horizontal Pole Mounting:

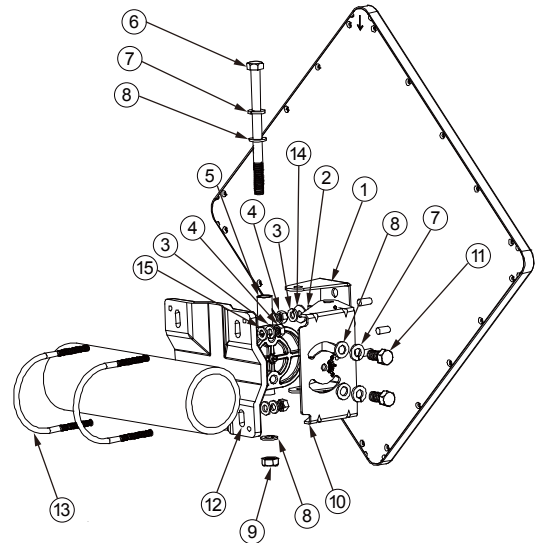

##### Horizontal Polarization

##### Horizontal Pole Mounting:

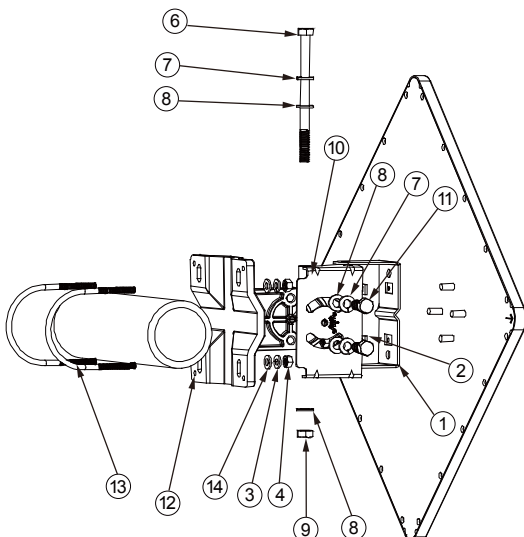

##### Horizontal Polarization

##### Vertical Pole Mounting:

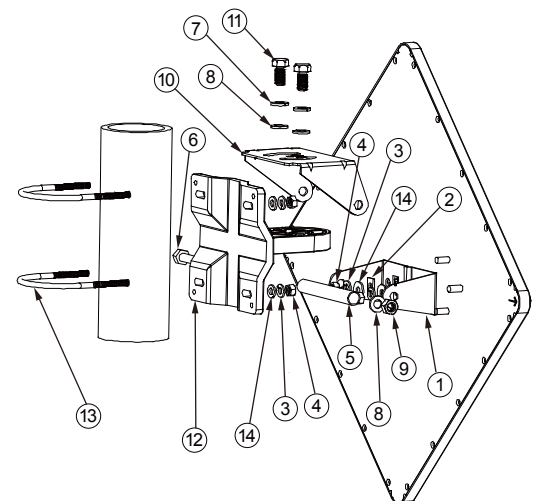

- |                       |      |
|-----------------------|------|
| 1. M-Type Bracket (L) | 1Pcs |
| 2. Space Keeper       | 2Pcs |
| 3. Spring Washer      | 6Pcs |
| 4. M6-1.0 Nut         | 6Pcs |
| 5. Steel Tube 93.2 mm | 1Pcs |
| 6. XHM8-1.25 x 120    | 1Pcs |
| 7. M8 Spring Washer   | 3Pcs |
| 8. M8 Washer          | 4Pcs |

- |                         |      |
|-------------------------|------|
| 9. M8 Nut               | 1Pcs |
| 10. Rotating Bracket    | 1Pcs |
| 11. XHM8-1.25 x 20      | 2Pcs |
| 12. Mounting Main Frame | 1Pcs |
| 13. U-Type Screw        | 2Pcs |
| 14. M6 Washer           | 6Pcs |



Note

Mounting pole diameter: 2"~3"

## Mounting Configuration

### 5GHz 23dBi Flat Panel Directional Antenna

#### Wall Mount

There are up/down and left/right tilting features for both vertical and horizontal polarization orientations.

Please make sure you have installed the ANT-FP23A of the same polarization with the other corresponding antenna of the outdoor AP.

#### Vertical Polarization Wall Mounting:

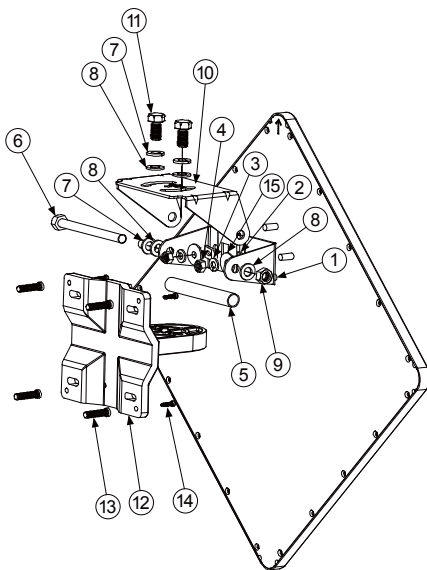

- |                       |      |
|-----------------------|------|
| 1. M-Type Bracket (L) | 1Pcs |
| 2. Space Keeper       | 2Pcs |
| 3. Spring Washer      | 6Pcs |
| 4. M6-1.0 Nut         | 6Pcs |
| 5. Steel Tube 93.5 mm | 1Pcs |
| 6. XHM8-1.25 x 120    | 1Pcs |
| 7. M8 Spring Washer   | 3Pcs |
| 8. M8 Washer          | 4Pcs |

#### Horizontal Polarization Wall Mounting:

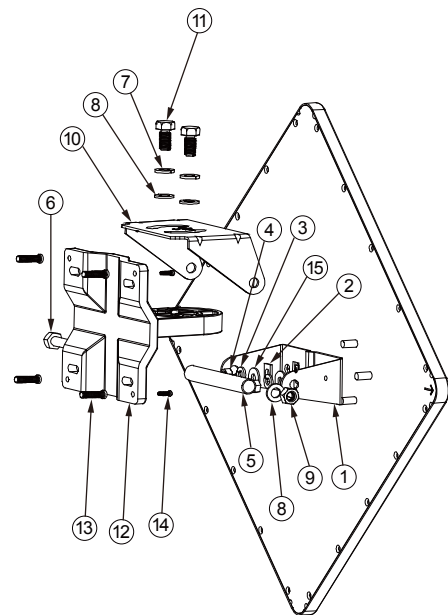

- |                         |      |
|-------------------------|------|
| 9. M8 Nut               | 1Pcs |
| 10. Rotating Bracket    | 1Pcs |
| 11. XHM8-1.25 x 20      | 2Pcs |
| 12. Mounting Main Frame | 1Pcs |
| 13. Wall Tiger          | 4Pcs |
| 14. TH 5/32-16 x 1"     | 4Pcs |
| 15. M6 Washer           | 2Pcs |



#### OUTDOOR INSTALLATION WARNING

##### IMPORTANT SAFETY PRECAUTIONS:

**LIVES MAY BE AT RISK!** Carefully observe these instructions and any special instructions that are included with the equipment you are installing.

#### CONTACTING POWER LINES CAN BE LETHAL.

Make sure no power lines are anywhere where possible contact can be made. Antennas, masts, towers, guy wires or cables may lean or fall and contact these lines. People may be injured or killed if they are touching or holding any part of equipment when it contacts electric lines. Make sure there is NO possibility that equipment or personnel can come in contact directly or indirectly with power lines.

Assume all overhead lines are power lines.

The horizontal distance from a tower, mast or antenna to the nearest power line should be at least twice the total length of the mast/antenna combination. This will ensure that the mast will not contact power if it falls either during installation or later.

